

Judicial de...

Calle Charid

Manzana...

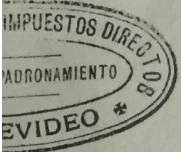

JUAN MANUEL BLANES

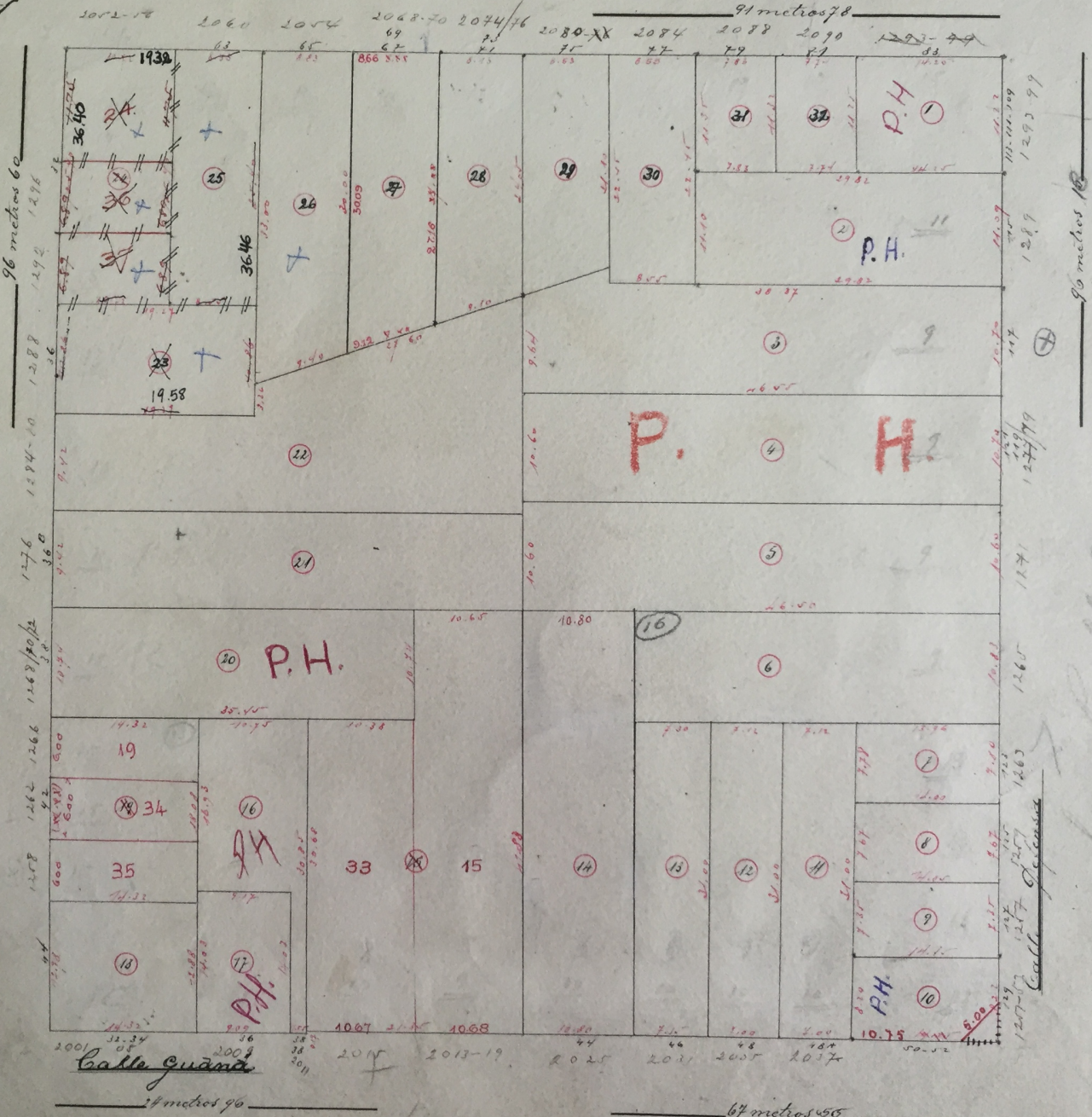

Calle Pablo de Maria



Rectificado
Monte Diabolo 1 de 1909

Abontando Jansen de 1909
Suzuya's

no.

Manuel
Calle Juan Blanes

Calle Guand

67 metros 50

96 metros 60

96 metros 60

91 metros 78

2002-08 2060 2074 2088-70 2044/16 2080-XX 2084 2088 2090

13

12

10